



REPOV plant

ITW - We are Global



52

Countries

~43,000

Employees

~18,500

Patents

\$12.6

Billion Revenue

ITW - Automotive Segment

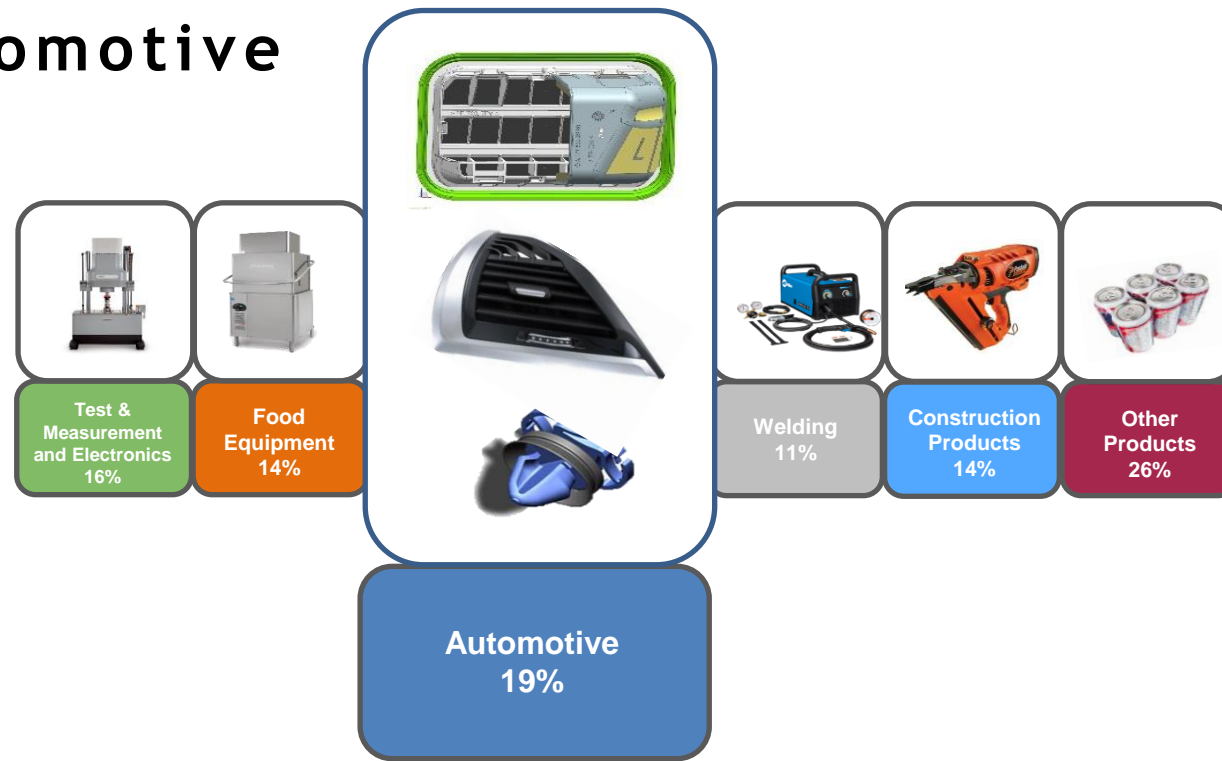

OEM Customers



System Suppliers - Tier Customers



ITW AFM - Global and Diverse



11 Engineering Locations 



8 Production Plants 



10 Sales Locations 

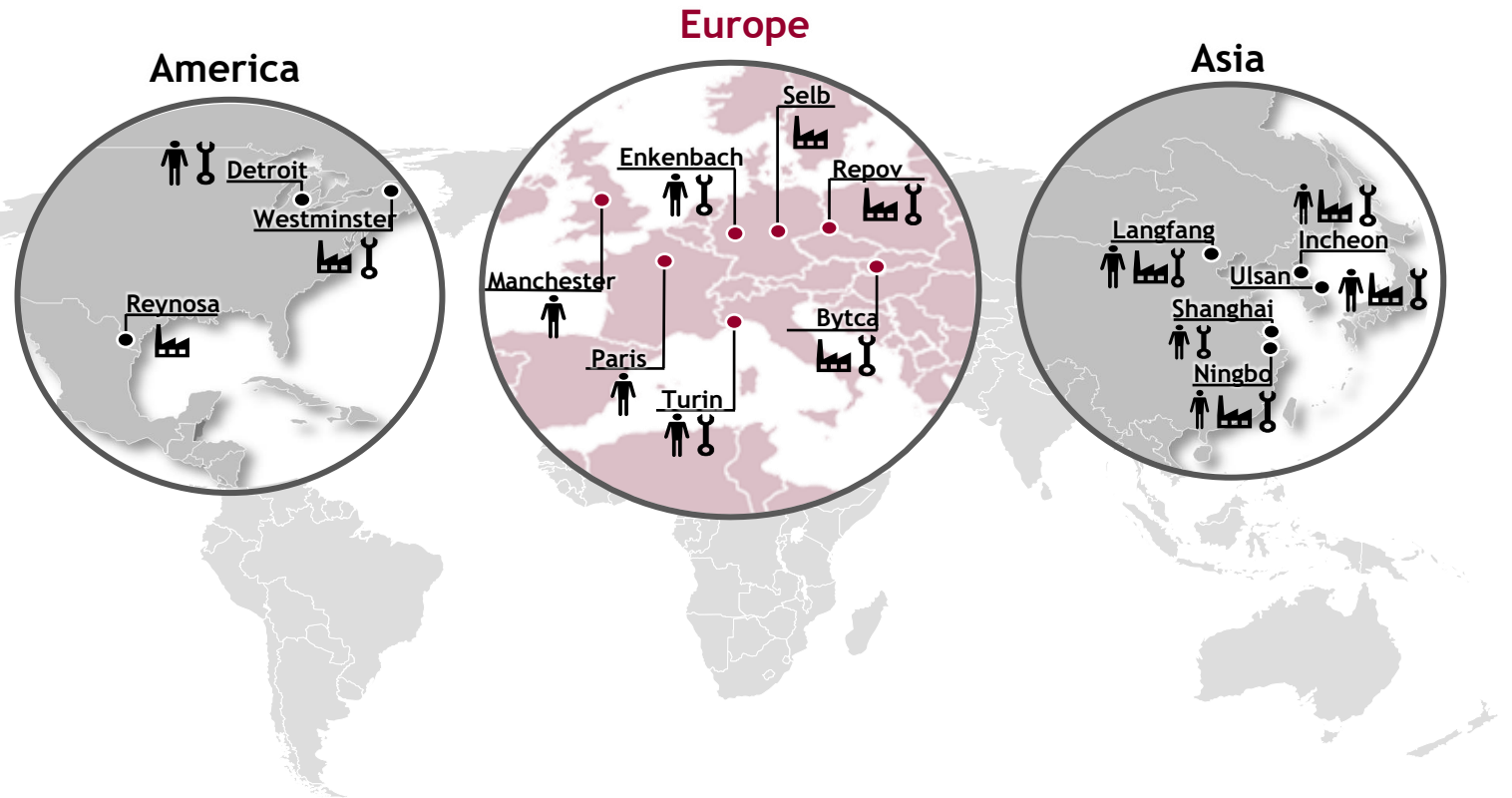

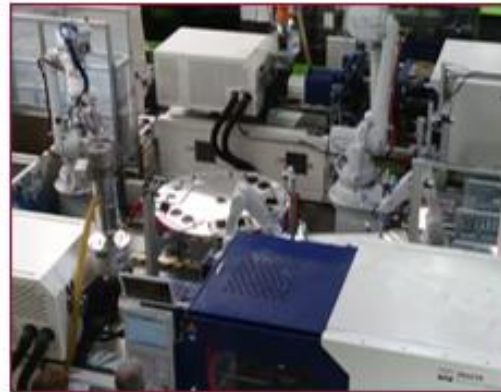

AFM Europe - Plants



ITW AFM Repov, Czech Republic



-  Location: Repov, 45 km North of Prague, Czech Rep.
-  Production space: 3.945 sq.m.
-  Established in 1992
-  Revenues 2022/23: \$ 24,7/33,1 Million

-  Employees: 258
-  Certifications: IATF 16949, ISO 14001
-  Customers: VW Group, RSA Group, FCA Group, Ford, Volvo
-  Products: Air Registers, PRVs

Capabilities

Products



AR - VW T-Cross In-lining & automation



In-lined - PRV Cell

- Injection molding : 60 presses (10 to 650 tons)
- Overmolding & high level of automation
- Internal tool shop for maintenance and set-up
- Sales, Product Design & Innovation



ITW Repov - Global Manufacturing Leader for PRV's

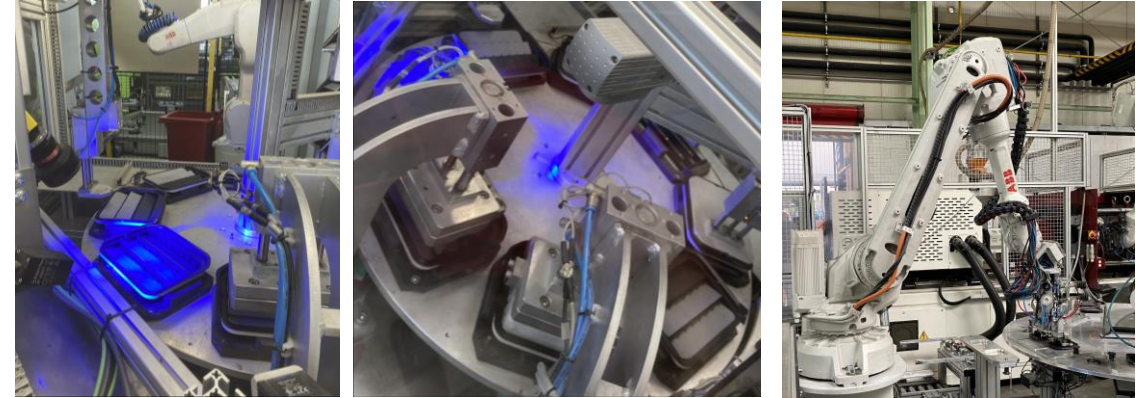

- 4 production halls mainly for PRV's
- 28 million parts installed annual capacity
- 1.500 m² dedicated to PRV Production
- Customized manufacturing concepts:
- 2K Injection, 2K Overmolding, 1K+ Foaming
- 18 Fully automatic production cells
- 121 Robots (ABB, Yaskawa, Sepro, Fanuc, Epson, Wittmann, Mitsubischi, Staubli)



Product Portfolio – Pressure Relief Valves



Daimler
E-Class S213



Daimler
A/B Class



Daimler
GLC



Ford Fiesta &
Puma

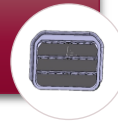

Ford Transit
several Models

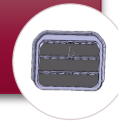

Renault/Nissan
several
platforms



FCA several
platforms



Toyota
Aygo

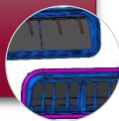

JLR several
platforms



Volvo
SPA Platform



VW Group
several
platforms

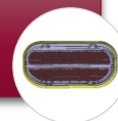

VW Group
several
platforms

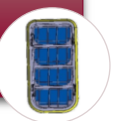

ITW Repov - Air register Production

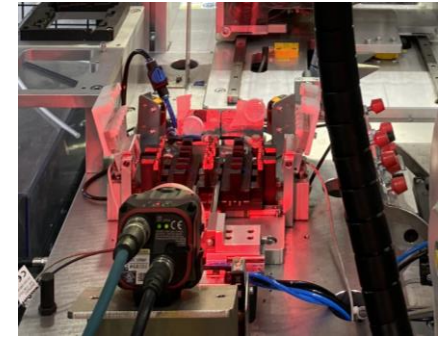

- Air register
- Capacity +1 Million Air register / Year
- 1.300 m² Production Area
- In-Lining, Glueing, Ultrasonic Welding

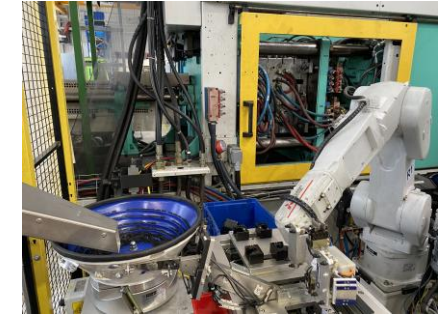

Product Portfolio - Air Registers



Fiat
New 500



Mercedes
Sprinter



PSA
Citroen C3



Daimler
A/B Class



Renault
Logan



Fiat Panda



Fiat
500



Jeep
Renegade



VW
T-Cross



VW
Golf 8

